

NOTES

METAL SHEET ROOFING TO COMPLY WITH PART 3.5.1.3. OF THE BCA
WHEREVER POSSIBLE HAVE THE SHEETS LAID SO THAT THE SIDE LAP IS
FACING AWAY FROM PREVAILING WEATHER.
DOUBLE SIDED ALUMINIUM FOIL SARKING ON GALVANIZED BIRD WIRE (OR
SIMILAR) AS REQUIRED. SARKING SHALL BE CONTINUOUS OVER HBS AND
RIDGES AND DRESSED OVER AND INTO EAVES. GUTTERS AND VALLEYS.
SHEETS MUST BE LAID WHEREVER POSSIBLE USING COMPLETE LENGTHS
FROM RIDGES TO EAVES.
SHEET METAL ROOF FLASHINGS, CAPPINGS AND FLASHINGS OR
PENETRATIONS ARE TO COMPLY WITH PART 3.5.1.3(g) AND (h) OF THE BCA.
ALL UPVC DOWNPIPES TO BE JOINTED WITH APPROVED SOLVANT AND PRIMER.
REFER TO ENGINEERS DETAILS FOR ROOF FRAMING.

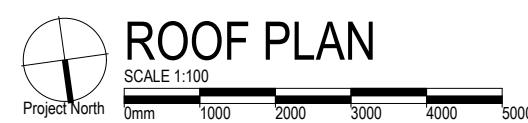
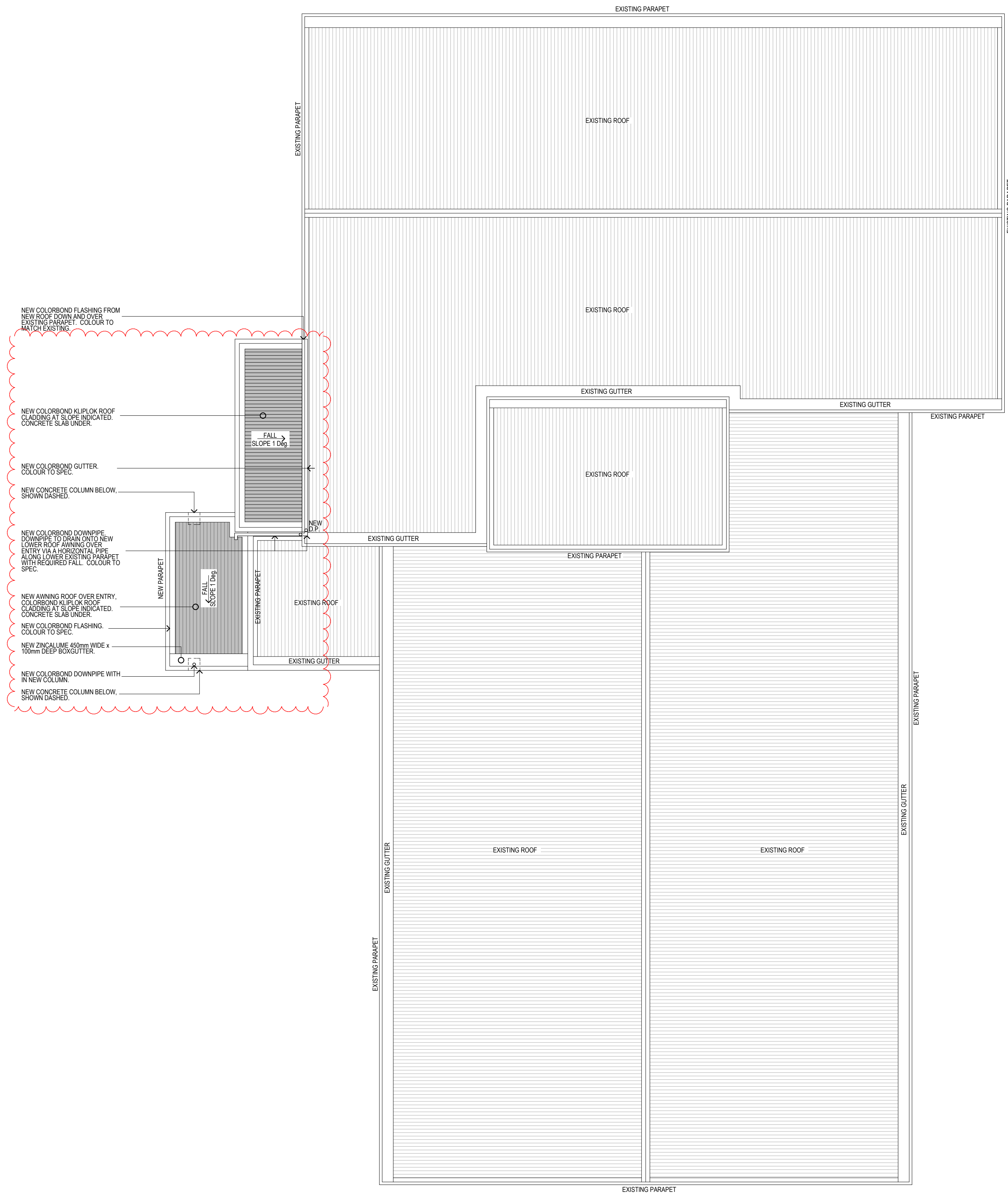

ROOF PLAN

Revision	Date	Description	By	App'd
C3	04-07-11	ALL AMENDMENTS SINCE TENDER STAGE. AS CLOUED, FOR CONTRACTOR	JB	HM
C4	17-06-11	AMENDMENTS: AS CLOUED	JB	HM
C3	26-05-11	AMENDMENTS: AS CLOUED	JB	HM
C2	05-04-11	AMENDMENTS: AS CLOUED	JB	HM
C1	24-03-11	BUILT FOR CONSTRUCTION	JB	HM



ARCHITECTURE
PLANNING
INTERIORS
Sydney
Suite 402
410 Elizabeth Street
Surry Hills NSW 2010
T 02 9211 9669
F 02 9211 9665
Internet
www.artas.com.au
e-mail
sydney@artas.com.au



Project Title
**GREY & FERGUSON
STREETS, GLENN
INNES**

Drawing Title
ROOF PLAN

Plot Date 4/07/2011	Approved HM	Drawn JB	Scale N/A
Project Number 102050	Drawing Number A1900/C5	Sheet Number N/A	

C O N S T R U C T I O N

Use figured dimensions in preference to scaled dimensions. All dimensions to be verified on site.
COPYRIGHT These drawings and designs and the copyright there of are the property of Artas Architects and must not be used, retained or copied without the written permission of Artas Architects. (a.b.n. 35 090 405 903)